







Site 8

DRAFT - FOR INFORMATION ONLY

- KEY**
-  EXISTING DROPPED KERBS
 -  PROPOSED DOUBLE YELLOW ROAD MARKINGS
 -  EXISTING TACTILE PAVING
 -  PROPOSED ROAD HUMPS MARKING
 -  PROPOSED ROAD MARKINGS TO BE MARKED IN WHITE THERMOPLASTIC
 -  PROPOSED RAISED TABLE
 -  EXISTING ROAD MARKINGS

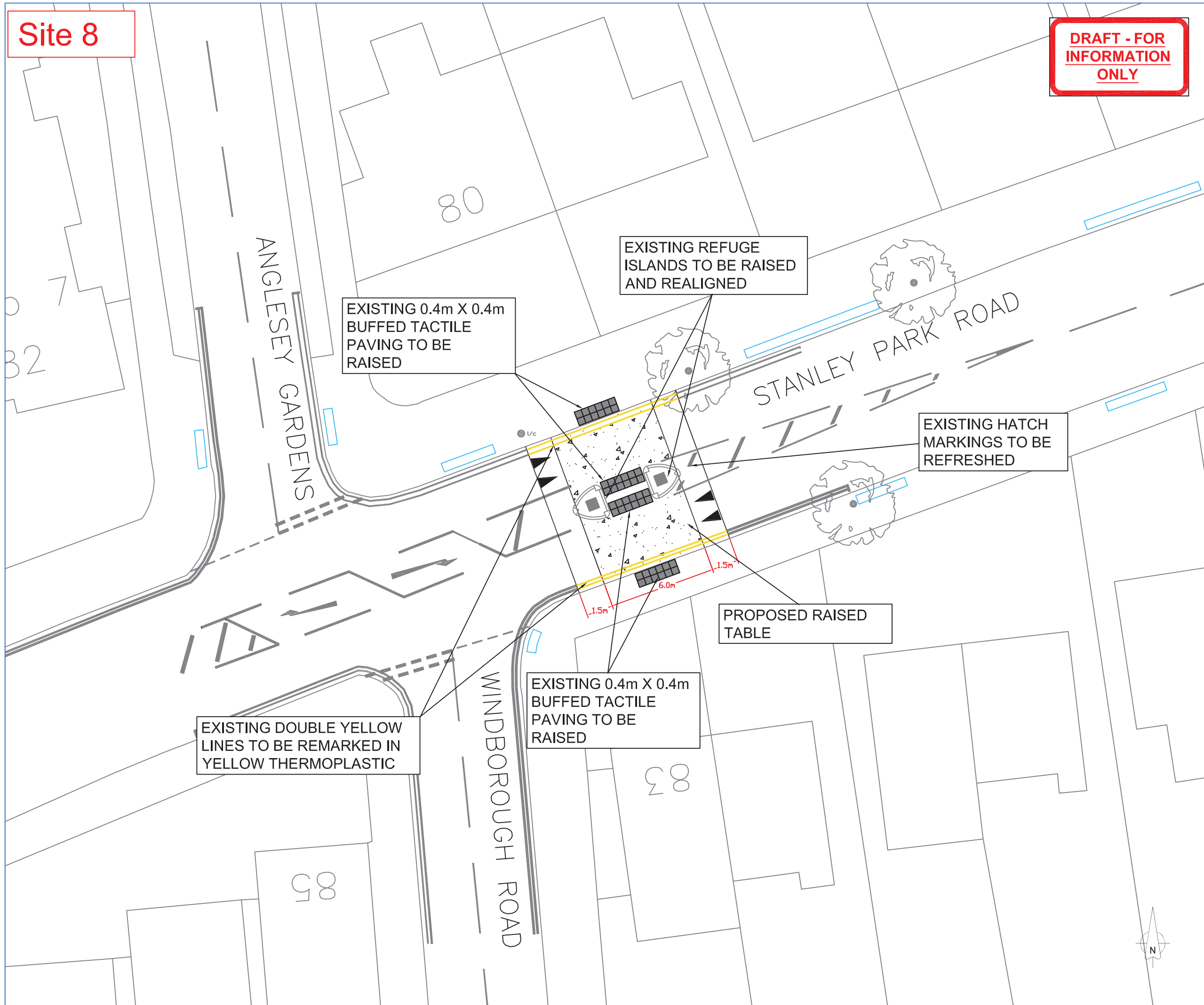

This map is reproduced from Ordnance Survey material with permission of Ordnance Survey on behalf of the controller of Her Majesty's Stationery Office (c) Crown Copyright. Unauthorised reproduction infringes Crown copyright and may lead to prosecution or civil proceedings. London Borough of Sutton 100008655X (2021).

No.	Amendment	Date	Int'l



KINGSTON AND SUTTON SHARED ENVIRONMENT SERVICE

Scheme
 STANLEY PARK ROAD & ANGLESEY GARDENS SITE - 8

Drawing Title
 PROPOSED RAISED TABLE GENERAL LAYOUT

ALEX CONSTANTINIDES
 INTERIM ASSISTANT DIRECTOR TRANSPORTATION, HIGHWAYS AND REGULATORY SERVICES
 KINGSTON AND SUTTON
 LONDON BOROUGH OF SUTTON
 24 DENMARK ROAD
 CARSHALTON SM5 2JG

Date	JAN 2021	Designed	MDH
Scale	N.T.S	Drawn	STH
CAD No.	T30152	Chk'd	GV
		App'd	HW

DRG.NO. T30152-P-037