









Site 2 & 3

**DRAFT - FOR INFORMATION ONLY**

- KEY**
-  EXISTING DROPPED KERBS
  -  PROPOSED DOUBLE YELLOW ROAD MARKINGS
  -  PROPOSED RAISED TABLE
  -  PROPOSED TACTILE PAVING
  -  PROPOSED ROAD HUMP MARKING
  -  PROPOSED TRAFFIC ISLAND
  -  EXISTING ROAD MARKINGS TO BE REMOVED
  -  EXISTING ROAD MARKINGS
  -  PROPOSED ROAD MARKINGS

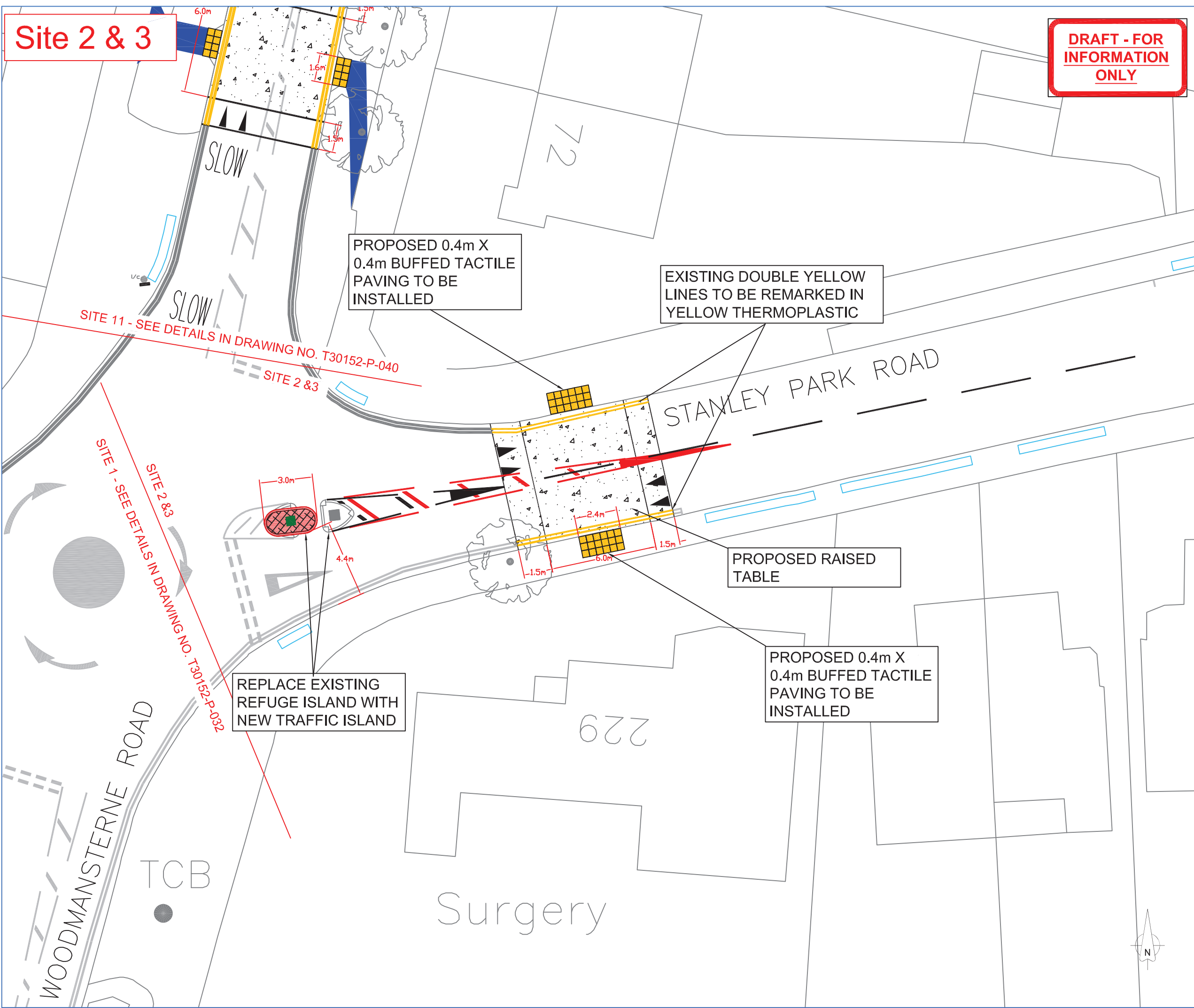

This map is reproduced from Ordnance Survey material with permission of Ordnance Survey on behalf of the controller of Her Majesty's Stationery Office (c) Crown Copyright. Unauthorised reproduction infringes Crown copyright and may lead to prosecution or civil proceedings. London Borough of Sutton 100008655X (2021).

No.	Amendment	Date	Int'l



KINGSTON AND SUTTON  
SHARED ENVIRONMENT SERVICE

Scheme  
STANLEY PARK ROAD  
WOODMANSTERNE ROAD  
SITE-2&3

Drawing Title  
**PROPOSED SPEED TABLE  
GENERAL LAYOUT**

ALEX CONSTANTINIDES  
INTERIM ASSISTANT DIRECTOR TRANSPORTATION,  
HIGHWAYS AND REGULATORY SERVICES  
KINGSTON AND SUTTON  
LONDON BOROUGH OF SUTTON  
24 DENMARK ROAD  
CARSHALTON SM5 2JG

Date	JAN 2021	Designed	MDH
Scale	N.T.S	Drawn	STH
CAD No.	T30152	Chk'd	GV
		App'd	HW

DRG.NO. T30152-P-033