

# Adult Social Services Housing & Health

## EXTENDING THE USE OF SUTTON INCLUSION CENTRE EASY READ CONSULTATION DOCUMENT

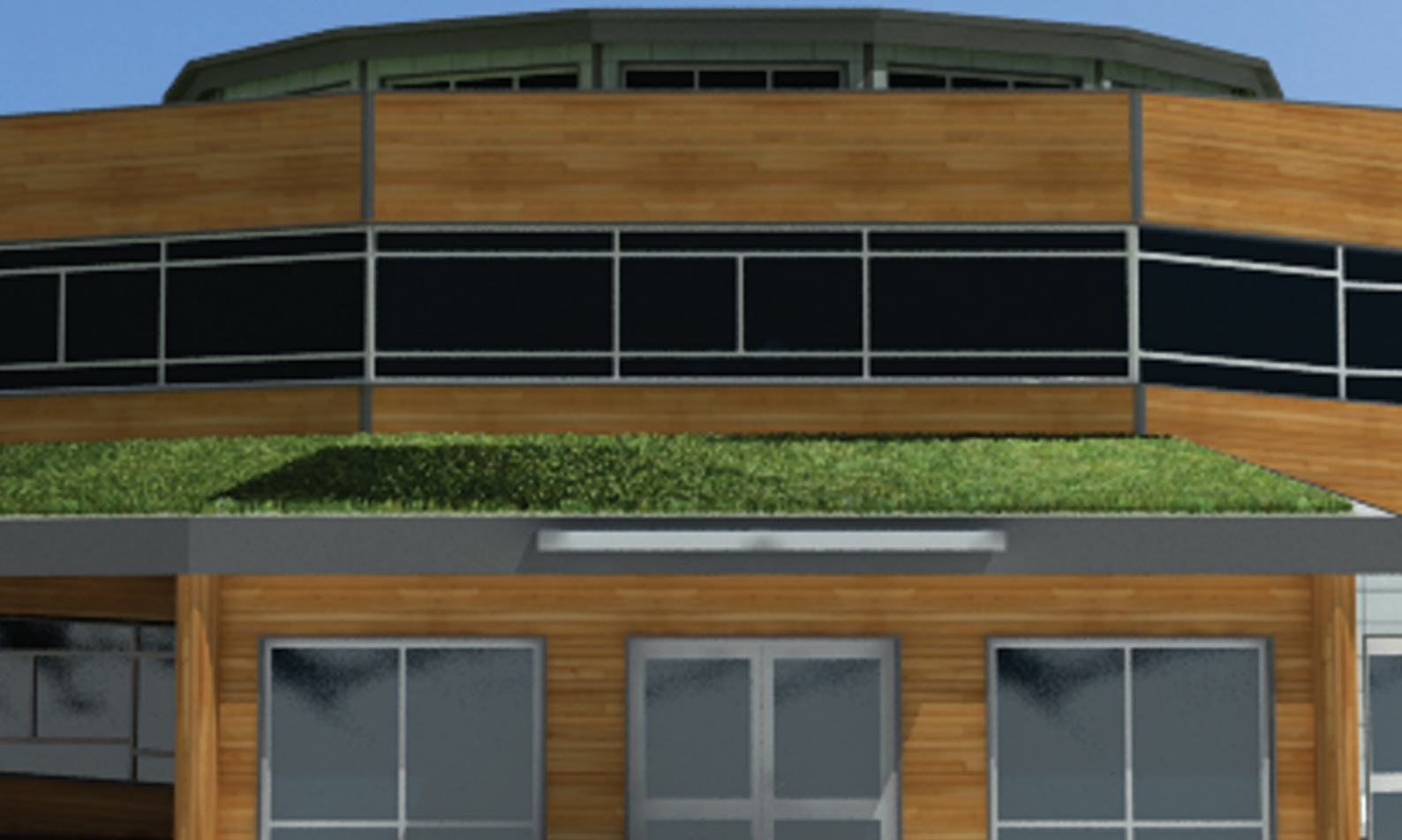

take part, take pride



## 1. Introduction

The Council wants to talk to people about Sutton Inclusion Centre.

The Inclusion Centre is only used by people with learning disabilities.

We want to talk to you about our ideas to allow more people with disabilities to use the Centre.

We want Sutton Inclusion Centre to become:

A resource centre and community hub for adults and young people in Sutton who have disabilities or complex needs.

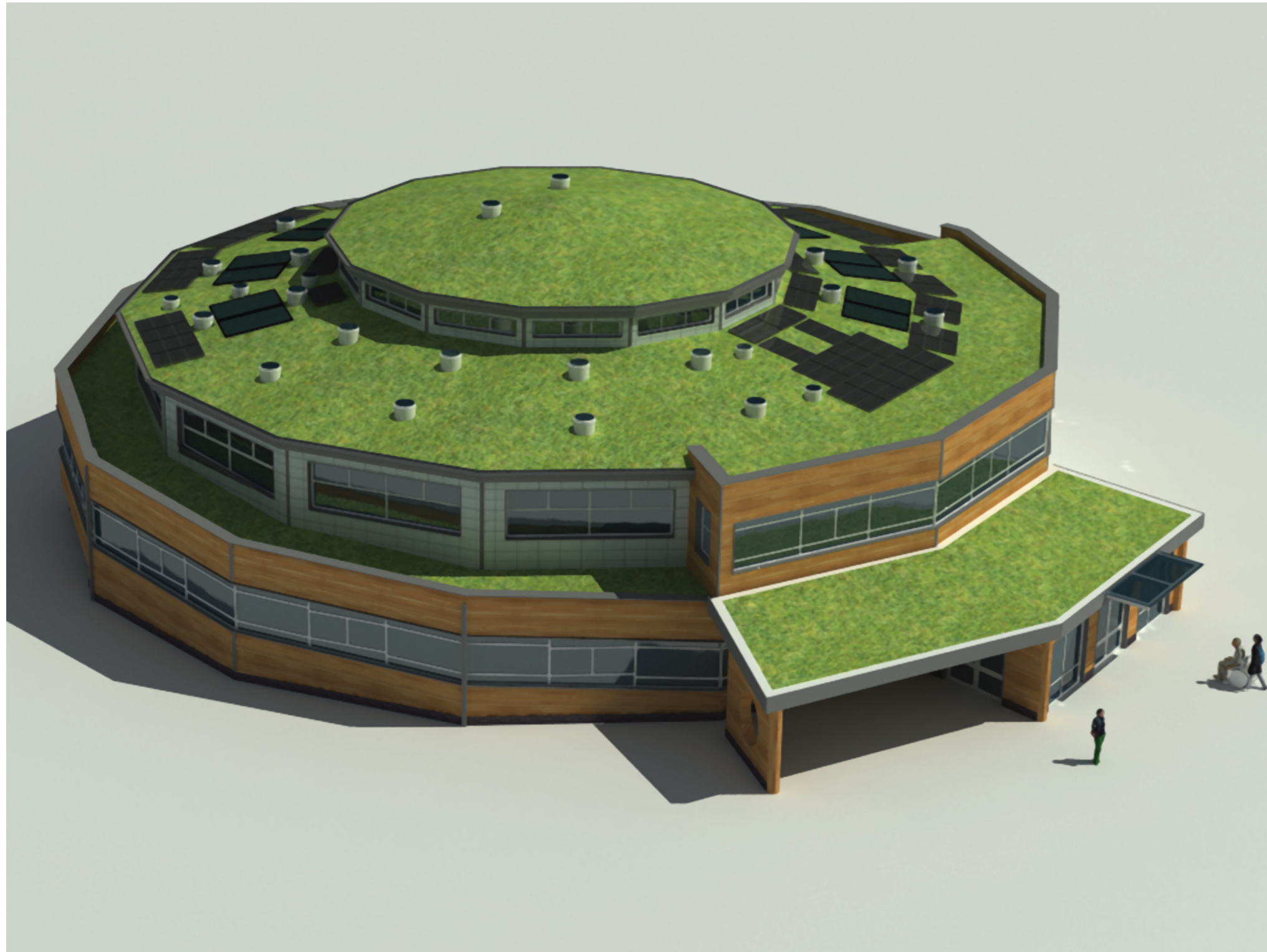

## 2. What is on offer at the Centre?



Lots of things are available for people with disabilities at Sutton Inclusion Centre such as:

- Sensory Rooms
- Aqua Therapy
- Physiotherapy Rooms
- IT Equipment
- Art Rooms and other activity rooms



## 3. Charges for the use of Rooms and Equipment

To enable more people with disabilities to use the Centre people would need to pay. Organisations could hire rooms to provide services to people with disabilities.

The list of costs for the use of rooms and equipment is at the back of this document.

## 4. How will the people who use the centre now be affected?

1. The people using the Centre now will be still be able to use the Centre in the future
2. The people using the Centre now will be protected from charges so that these proposals do not affect them.

## 5. Consultation

We want to talk to people about the things in this document between

18th November 2013  
to 13th January 2014

If you want to talk to someone about the things you have read in this document you can call Alan Grierson or Pier Poli.

**Tel: (020) 8770 5771**

**Email: alan.grierson@sutton.gov.uk**

**Tel: (020) 8770 4941**

**Email: pier.poli@sutton.gov.uk**

Rooms could be booked by:

- Individuals
- Groups of people
- Organisations

## 6. List of proposed Charges

Room	Facilities available	Cost
Sensory Rooms	Three sensory rooms are available with varied equipment (light room, dark room, interactive room)	£7.60 per hour
Welcome rooms	2 Large Rooms (43m2 each) with tables chairs etc next to kitchen area.	£23.20 per hour
Kitchen area	The kitchen area is fully fitted has availability for cookery sessions.	£20.80 per hour
Art Rooms	Low cost consumables, including paints and brushes are included in the price of the room, high cost consumables for specific projects need to be either sourced by user or charged at cost.	£14.50 per room per hour
Physiotherapy Rooms	These two rooms are currently used exclusively by the specialist LD health team. Equipment is provided serviced and maintained by Physiotherapy Services.	£14.90 per room per hour
Activity Rooms	Activity rooms have limited furniture and houses a range of musical instruments.	£14.90 per hour
Interactive Technology Suite	Facilities include a range of equipment designed for use by people with profound learning disabilities	£16.00 per hour
Meeting Rooms	There are three small meeting rooms all charged at the same average price.	£7.00 per hour
Relaxation room	Contains some sensory equipment.	£7.90 per hour
Hot desk room	The hot desk room contains seven computer terminals. The costs are calculated on a room area basis but distributed between terminals.	£3.30 per station per hour
Aqua Therapy Suite (excluding pool side assistance)	Aqua Therapy Pool, 2 accessible user changing areas, staff changing area. The Pool can accommodate up to three people at any one time (with carers).	£49.50 per hour without poolside assistance £75 per hour with poolside assistance

